

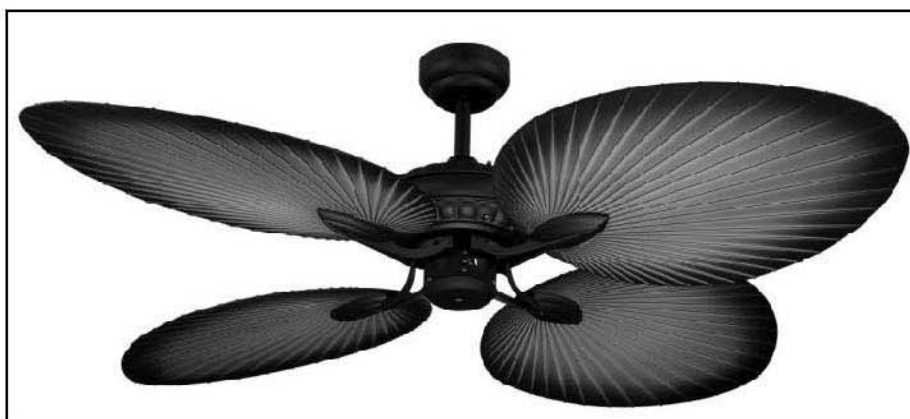

OASIS

Series

52" CEILING FAN
INSTRUCTION BOOK



MODEL: MOF134OB

Thank you for purchasing your Martec product. Please read all instructions carefully before assembly and use.

IMPORTANT SAFEGUARDS

READ THESE INSTRUCTIONS CAREFULLY BEFORE INSTALLING OR USING THE PRODUCT.KEEP THE INSTRUCTIONS HANDY FOR FUTURE REFERENCE.

SAFETY

Installation of fans must follow SAA standards and meet local and regulatory authority regulations. A fully qualified and licensed electrician lawfully MUST carry out the installation.

Means for disconnection must be incorporated into the fixed wiring in accordance with the wiring rules. Fan and light MUST be earthed.

Mounting bracket must be firmly attached to a solid structure i.e. concrete ceiling, steel structure or timber frame etc. and MUST be nailed between beams if timber option is required.

WARNING

Only approved Martec speed controllers and remote controls should be used for the operation of Martec fans. The use of unauthorized controllers will VOID the warranty.

DO NOT mix blades from one fan to another. All blades MUST be replaced if damaged.

Important: Always operate the product from a power source of the same voltage, frequency and rating as on the product identification plate.

Important: The fan is to be installed so that the blades are more than 2.1 metres above the floor.

Fan blade assembly can also be done on the floor prior to installing on the ceiling. This can be done by placing the fan on the foam insert provided in the carton.

Important: Be careful not to bend the blades when installing them on the floor as this will cause the fan to be unbalanced and wobble and cannot be rectified without replacing the full set of blades.

Avoid contacting moving parts. Keep hands, hair and clothing well away from the product while it is in operation,

This appliance is not intended for use by persons (including children) with reduced physical, sensory or mental capabilities, or lack of experience and knowledge, unless they have been given supervision or instruction concerning use of the appliance by a person responsible for their safety.

Young children should be supervised at all times to ensure that they do not play with the appliance.

Do not operate any product which has been/or appears to be damaged in any manner or after the product malfunctions.

CAUTION: To reduce the risk of electric shock, do not install the product where it can be exposed to rain, moisture or any liquid.

Do not operate this product in the presence of explosive fumes and/or flammable liquid.

Do not use the product for anything other than its intended use as described in these instructions. This product is intended for normal domestic household use only. The use of accessory attachments other than those recommended by the manufacturer may cause safety hazards.

BEFORE INSTALLING:

1. Unpack the fan and carefully identify the parts, refer to assembly and parts drawing in the back of this manual.
2. Handle the motor assembly and blades with care. Place the motor on a cloth or a soft surface to ensure that it is not scratched.
3. If installing more than one fan, ensure that the blades are not mixed together, as each set is matched and balanced. If blades are mixed, the fan will wobble. If one blade is damaged all blades must be replaced.

NOTE: Martec Pty Ltd assumes that the installation of this ceiling fan is carried out as per the instruction manual i.e. mounted to a solid timber structure. It is the purchaser's responsibility to ensure that the installing electrician has carried out the installation of this ceiling fan as per the instruction manual. Should any noise emanate from this ceiling fan it is the purchaser's responsibility to have their electrician check the installation of the fan. Steel beams, grid ceilings and flexible surfaces will not absorb vibration and may cause some audible noise due to the vibration. THIS IS NOT A FAULT AND IS NOT COVERED UNDER WARRANTY.

4. Choose a suitable location where mounting bracket can be solidly mounted to a ceiling joist or beam.
5. Use the long wood screws supplied to secure the mounting bracket to the selected fixing point. Ensure that at least 40mm of the screw is threaded into the supporting joist or beam.
6. The wiring can now be installed ready for connection to the terminal strip in the ball joint canopy of the fan.
7. Three wires are required for fan operation, 4 wires if fan/light combination.
8. Wiring requirements at terminal strip:
 - 1 x earth wire
 - 1 x neutral wire
 - 1 x switched active for fan
 - 1 x switched active for light (only if light fitted).

ASSEMBLING THE FAN:

9. Secure the hanger bracket to ceiling beam or a suitable piece of timber inserted between the ceiling beams. Martec Pty Ltd recommends bracket be attached with two (2) long screws as supplied within the package.
10. Place fan into hanger bracket and align ball joint slot with hanger bracket. After wiring is completed attach the canopy to the hanger bracket by pushing upwards and twisting anti-clockwise, locate screws in keyholes and tighten.

INSTALLING BLADES:

11. Assemble the blade holders to the blades using screws and washers provided.
12. Attach blades to the fan motor using screws and washers provided.

Note: IF A LIGHT FITTING IS BEING FITTED TO THE FAN CONTINUE TO STEP 13.

IF NO LIGHT IS BEING FITTED TO THE FAN CONTINUE TO STEP 18 AND THEN STEP 22.

INSTALLING THE LIGHT:

13. Unscrew the decorative cup from the bottom of the fan motor and remove the plug from the centre hole.
14. Insert light fitting with threaded nipple attached through the centre hole and attach with nut and washer.
15. Connect light wires from the fan to the wires from the light fitting using approved connectors or terminal block.
16. Re attach decorative cup and light fitting to the fan using the screws and washers provided.
17. Install light globes taking care not to exceed the maximum recommended wattage specified in the light fitting.

INSTALLING WALL CONTROL:

18. The speed control and the light switch require an unswitched active.
- a. connect unswitched (permanent) active to wire in terminal block marked "AC-L 240v /50hz".
 - b. connect switched active wire for fan to wire in terminal block marked "FOR FAN - L".
 - c. connect switched active wire for fan light to wire in terminal block marked "FOR LIGHT-L".

HOW TO USE THE FAN/LIGHT:

19. Select the position of the reverse switch on the fan.
- Warm weather - have the air-flow directed downwards.
- Cooler weather - have the air-flow directed upwards
20. Select the desired speed on the wall control by turning the knob to:
- "1" ... "2" ... "3" ...
- position "0" is the off position.
21. Use your light switch to turn the light on or off.

AFTER INSTALLATION:

WOBBLE:

22. Should the fan have excessive wobble ensure that the tip of each blade is cutting through the air at the same point. This can be checked by measuring the distance from the ceiling to the tip of each blade. Correct any difference by adjusting the blade or blade holder.

Also be sure to check all blade screws and all screws holding the down rod and ball joint are tight.

NOTE: Ceiling fans tend to move during operation due to the fact that they are mounted on a rubber grommet. If the fan was mounted rigidly to the ceiling it would cause excessive vibration.

Movement of a few centimetres is quite acceptable and does not suggest any problem.

NOISE:

23. When everything is quiet, especially at night, you may hear occasional small noises.

Slight power fluctuations and frequency signals superimposed in the electricity supply by your energy provider for the switching of off peak hot water and street lights may cause a change in the fan motor noise.

NOTE: Electronic speed controllers could damage this fan and also cause it to be noisy. The use of electronic speed controllers or any speed controller other than the controller included in the box will void the warranty.

SHOWN WITH LIGHT
(NOT SUPPLIED WITH ALL MODELS)

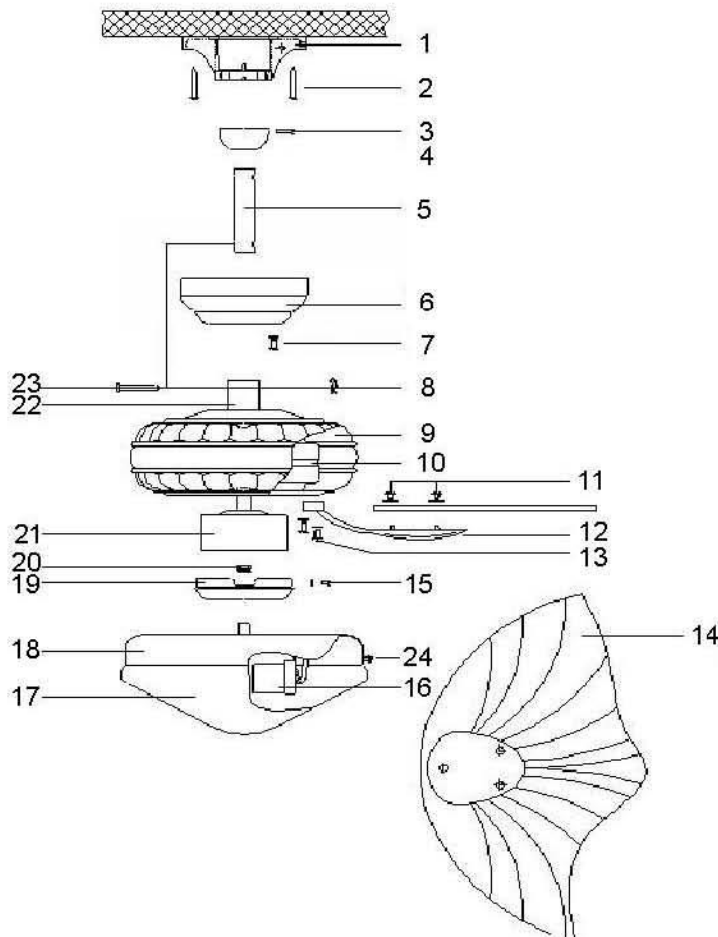

KEY#	DESCRIPTION	Q'TY
1	Hanging bracket	1
2	Screw	2
3	Screw	1
4	Hanging ball	1
5	Downrod	1
6	Canopy base	1
7	Screw/Spring washer	2
8	R pin	1
9	Motor cover	1
10	Motor	1
11	Screw for blade/Fiber washer	1
12	Blade holder	5
13	Screw for blade holder	15
14	Blades	10
15	Screw/Lock washer	4
16	Lamp holder	2
17	Glass	1
18	Lamp cover	1
19	Switch housing cover	1
20	Nut/Lock washer	1
21	Switch housing	1
22	Yoke	1
23	Pin	1
24	Screw	4

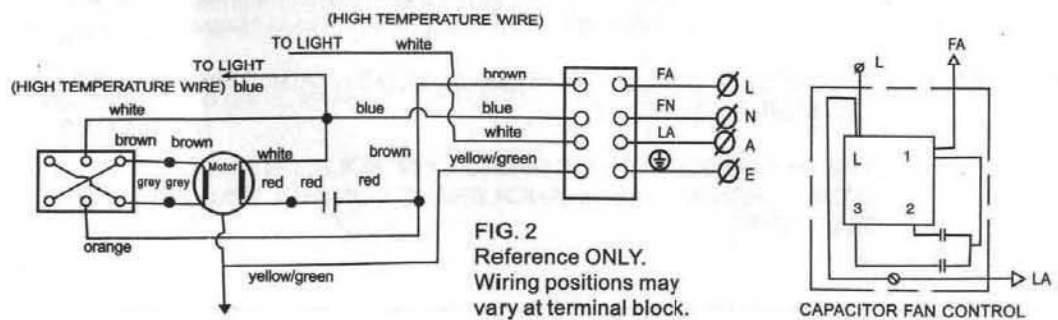

MARTEC PTY LTD: FULL 3 YEAR IN HOME WARRANTY

WARRANTY STATEMENT:

MARTEC PTY LTD warrants this product for a period of 3 YEARS "IN-HOME" WARRANTY FROM THE ORIGINAL DATE OF PURCHASE for residential situations subject to the following statement.

IMPORTANT NOTICE: MARTEC PTY LTD WARRANTS THIS PRODUCT FOR 3 YEARS FULL "IN-HOME" WARRANTY (PARTS INCLUDED), MARTEC PTY LTD ONLY WARRANTS THE FAN AGAINST FAULTY WORKMANSHIP AND SUBJECT TO THE CONDITIONS AND PROVISIONS SET OUT BELOW.

- 1) Warranty applies only if the product was purchased in Australia and does not transfer from the original purchaser. All ceiling fans replaced under warranty are only warranted for the balance of the warranty period.
- 2) The 3 year "in home warranty" does not extend to fan accessories such as remote kits AND light fittings (INCLUDING GLASS LIGHT SHADES) that have been fitted during or after the original ceiling fan installation. All wall controllers, ballasts, light fittings and remote controllers included in the original carton ONLY carry a 1 year warranty period. Remote Control, Wall Control and light kits must be Martec approved and branded units, any other branded unit will VOID the warranty. Globes are not covered under warranty. Any changes to plated &/or painted finishes due to climatic conditions or other circumstances deemed to be beyond the control of MARTEC PTY LTD or their authorised agent are NOT covered under this warranty. Threaded components such as blade nuts and screws can work slightly loose during normal operation. These should be tightened regularly to ensure the fan does not develop operation noises. If noises do develop, check this aspect before requesting service. **THIS IS NOT COVERED UNDER WARRANTY.**

PURCHASERS PLEASE NOTE:

3) Any claim made in relation to this warranty is solely limited to the cost of replacement of the product, parts and labour of the authorised service agent approved by MARTEC PTY LTD. No acceptance of other liability for incidental or consequential damage is covered. MARTEC PTY LTD does NOT cover travelling costs incurred by their SERVICE AGENT where service is requested by the purchaser outside of the MARTEC PTY LTD service network. The MARTEC PTY LTD service network is defined at our discretion yet is limited by the boundary of the city in which you live. Travel outside of the city limits by the MARTEC PTY LTD authorised service agent will incur commercial costs to be paid for by the purchaser at a rate calculated by the number of kilometres travelled beyond the city limits. Any service required outside of the service network will be provided in the following manner:

- a) A full replacement will be sent and a MAXIMUM payment of \$70 including GST will be sent (ONCE MARTEC PTY LTD HAS RECEIVED THE FAULTY FAN, MARTEC freight paid) for installing the replacement fan. All other costs over and above the \$70 including labour and travel costs are to be paid for by the purchaser. **PLEASE NOTE:** it is the responsibility of the purchaser to call the customer service number prior to any electrician leaving the job site if any problems occur.
- 4) This warranty becomes VOID if the product was not INSTALLED BY A QUALIFIED LICENSED ELECTRICIAN or has been tampered with, damaged, repaired by a non qualified electrician or becomes faulty in any way through improper use, normal wear and tear, accident, abuse, failure to use the product in accordance with the instructions relating to the installation.
- 5) This product is ONLY covered by this warranty for a period of 90 days when used in a commercial application.
- 6) Minor variations of speed between the same model fans may be evident and is not covered under this warranty. Any changes in climatic conditions deemed by MARTEC PTY LTD to be beyond their control are not covered under this warranty. Any damage caused to walls, ceilings, furniture, carpet or any consequential damage caused by the installation of this product is not covered under this warranty.
- 7) Repairs carried out by the Martec approved service agent due to incorrect installation will be charged to the purchaser at the time of service. This warranty is limited to the product being repaired/replaced ONLY by an approved MARTEC PTY LTD service agent and does not include costs where the original installation was not carried out per the instruction manual. The product warranty is limited to defects in workmanship only and does not apply to loss or damage caused by abnormal or excessive force of any kind from internal or external sources. This warranty does not cover electrical humming noises, wobbling or any other external influences.
- 8) Martec Pty Ltd reserves the right to change or amend any or all parts of this warranty statement at any time and without notice.
- 9) The costs associated with the hire of extension ladders and scaffolding to service ceiling fans installed on ceilings higher than 3 metres from the ground, will not be covered by this warranty. These costs will be borne by the customer not Martec Pty Ltd.

PLEASE NOTE: ALL CEILING FANS WILL MAKE SOME AUDIBLE NOISE, THIS WILL BE MOST EVIDENT AT NIGHT AND ESPECIALLY ON LOW SPEED SETTINGS. SLIGHT ELECTRICAL FLUCTUATIONS WILL CAUSE THIS, IT IS "NOT" COVERED UNDER WARRANTY. ALL SIGNALS SENT THROUGH BY THE ELECTRICITY SUPPLIER FOR OFF PEAK HOT WATER AND OTHER SIGNALS (RIPPLE CONTROL SIGNALS), FOR EXAMPLE STREET LIGHTING, MAY CAUSE INTERMITTANT HUMMING NOISES IN THE CEILING FAN, THIS IS NOT COVERED UNDER WARRANTY. A LIGHT FITTING WILL OFTEN ACCENTUATE NOISES AND VIBRATIONS AND CAN BE TRACED TO LOOSE GLASS FITTINGS OR OTHER COMPONENTS, THIS IS NOT COVERED UNDER WARRANTY.

PLEASE NOTE: Martec Pty Ltd assumes that installation of this ceiling fan is carried out as per the instruction manual (i.e. mounted to a solid timber structure). It is the purchaser's responsibility to ensure that the installing electrician has carried out the installation of this ceiling fan as per the instruction manual. Should any noise emanate from this ceiling fan, it is the purchaser's responsibility to have their electrician check the installation of the fan. Steel beams, grid ceilings and flexible surfaces will not absorb vibration and may cause some audible noise due to vibration. **THIS IS NOT A FAULT AND IS NOT COVERED UNDER WARRANTY.**

MARTEC PTY LTD ONLY covers manufacturing faults associated with the fan per the above warranty provisions. The warranty will not cover the entry of foreign matter or influences to the product including but not limited to liquid, moisture, dirt, dust or electrical fluctuations. Power supply faults or influences resulting in damage to this product are not covered under this warranty. The warranty does not cover any loss, damage or delay directly or indirectly caused by any malfunction of or defect of or failure of the product other than stated in this warranty.

PLEASE NOTE: STAINLESS STEEL REQUIRES REGULAR CLEANING. "TEA STAINING" IS A COMMON OCCURRENCE WITH ALL TYPES OF STAINLESS STEEL. THIS IS NOT A FAULT OF THE PRODUCT AND IS "NOT COVERED UNDER WARRANTY".

IMPORTANT NOTICE:

ALL CLAIMS FOR WARRANTY MUST BE ACCOMPANIED WITH THE COMPLETED WARRANTY CARD. THE WARRANTY CARD IS INCLUDED WITH THIS PRODUCT, INCLUDING THE SIGNED ACKNOWLEDGEMENT OF AGREEMENT OF WARRANTY WHICH FORMS PART OF THE WARRANTY STATEMENT. MARTEC PTY LTD ALSO REQUIRES THE CUSTOMER TO INCLUDE THE PURCHASE RECEIPT, ELECTRICIAN'S INSTALLATION COMPLIANCE CERTIFICATE, RECEIPT AND LICENSE NUMBER, THE PURCHASER'S FULL NAME AND DETAILS, THE FULL NATURE OF THE FAULT AND THE SERIAL OR P.O. NUMBER WHICH CAN BE LOCATED ON THE TOP MOTOR HOUSING. A SERVICE CALL WILL **NOT** BE INITIATED WITHOUT THE REQUIRED DOCUMENTATION.

CUSTOMER SERVICE HOTLINE: (PHONE) 1300 730 064

CUSTOMER SERVICE HOTLINE: (FAX) 02 9740 6724

CUSTOMER SERVICE OPERATES BETWEEN 9AM - 5PM EST MON-FRI

IMPORTANT: PLEASE DO NOT PHONE THE RETAILER FOR WARRANTY WORK. INSTEAD PHONE THE CUSTOMER SERVICE HOTLINE ON 1300 730 064 OR FAX ON 02 97406724.

MARTEC PTY LTD UNIT 182 13 GAREMA CIRCUIT, KINGSGROVE NSW 2208

Customer Details

Surname..... First name.....

Address

Daytime Ph..... A/h Ph

Warranty Details

Date of Purchase..... Date of Installation.....

Product Description

Store..... PO No.....

Installing Electrician Details

Name of Electrical Contractor.....

Company Name.....

License Number..... Ph

Address

I HEREBY ACKNOWLEDGE THAT I HAVE READ AND AGREE WITH THE MARTEC PTY LTD WARRANTY STATEMENT AND CONDITIONS OF WARRANTY SERVICE. I ACKNOWLEDGE THAT MARTEC PTY LTD RESERVES THE RIGHT TO CHARGE ME THE CUSTOMER \$77.00 INCLUDING GST PLUS THE COSTS OF ANY REPLACEMENT PARTS OR PRODUCTS (IF ANY USED) AND THE COSTS ASSOCIATED WITH SHIPPING THESE PARTS TO MY LOCATION SHOULD THE REPORTED FAULT NOT BE AN ACTUAL MANUFACTURING FAULT OR MALFUNCTION. THIS WILL BE ASSESSED BY THE AUTHORISED MARTEC SERVICE AGENT ON MY PREMISES. I THE CUSTOMER ACKNOWLEDGE THAT I WILL BE LIABLE FOR THIS CHARGE SHOULD THE AUTHORISED MARTEC SERVICE AGENT DETERMINE THIS TO BE THE CASE.

ANY FAILURE TO PAY ANY WARRANTY RECOVERY CHARGES FROM MARTEC PTY LTD WILL RESULT IN THE TERMINATION OF ANY REMAINING WARRANTY AND POSSIBLE DEBT COLLECTION PROCEDURES.

DATE:..... PRINT NAME:..... SIGNATURE:.....